

# Air lock device **PP /PT**



**DISCHARGE OF PROCESSED MATERIAL FROM THE SPACE WITH AIR PRESSURE DIFFERENT**

**AIR LOCK DEVICE PP, PT** is a piece of equipment to allow discharge of processed material from the space with air pressure different from the atmospheric to the space with normal pressure conditions. Process material can be grain, flour dust or order. For proper function of the air lock of higher moisture content than 14%, as well as sticky or extremely adhesive ones, are not suitable.



**PP 250**

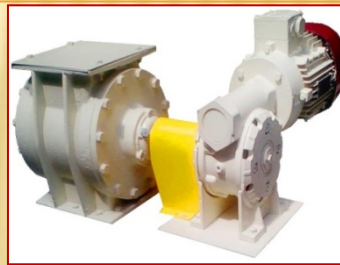

**PT 250**



**PT 315**

# Air lock device **PT 250**

The device consists of a case and a rotor. The machine case have their inlet and outlet flanges adapted for connecting of either adjoining conveyance routes or of the locked piece of equipment (the **PP 250** has got a ring inlet flange and a square outlet one, the **PT 200** flanges are both square ones). The locked in-line pieces of equipment are usually centrifugal dust separators. Inside the case there is a rotor mounted on a shaft projecting out from the case in various lengths to accept the driving geared motor or the neighbouring air locks.

PP 250

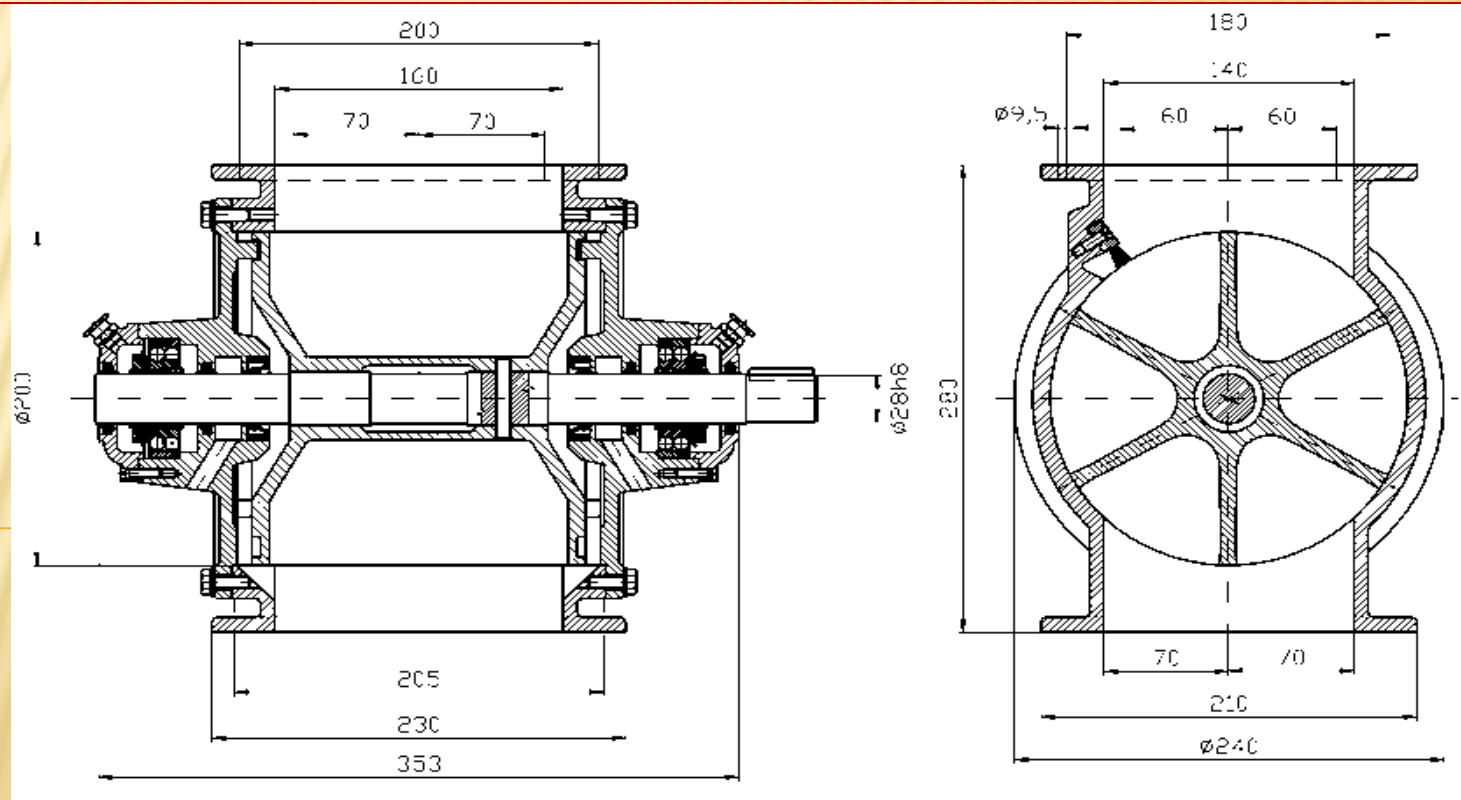

# Air lock device **PT 200 / 250 / 315**

TYPE	PT 200	PT 250	PT 315.2	PT 315.3
Nominal capacity (m <sup>3</sup> .h <sup>-1</sup> )	18	30	120	120
Weight (kg)	44	55	127	104
Drive speed (rpm)	70,5	70	70	70
Input (kW)	1,1	1,1	1,1	Without el.motor

PT 200

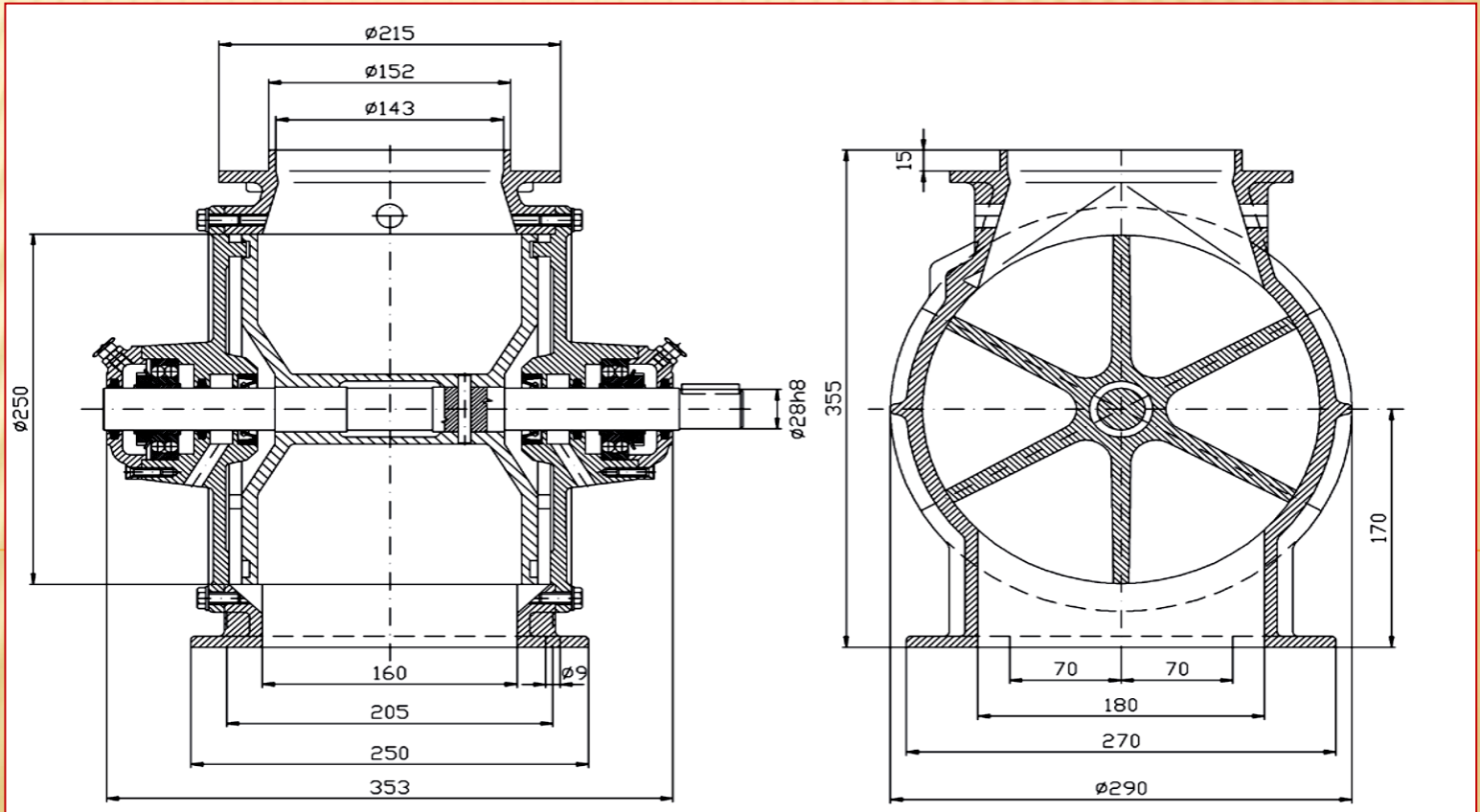



# Air lock device **PT 250** with electric motor

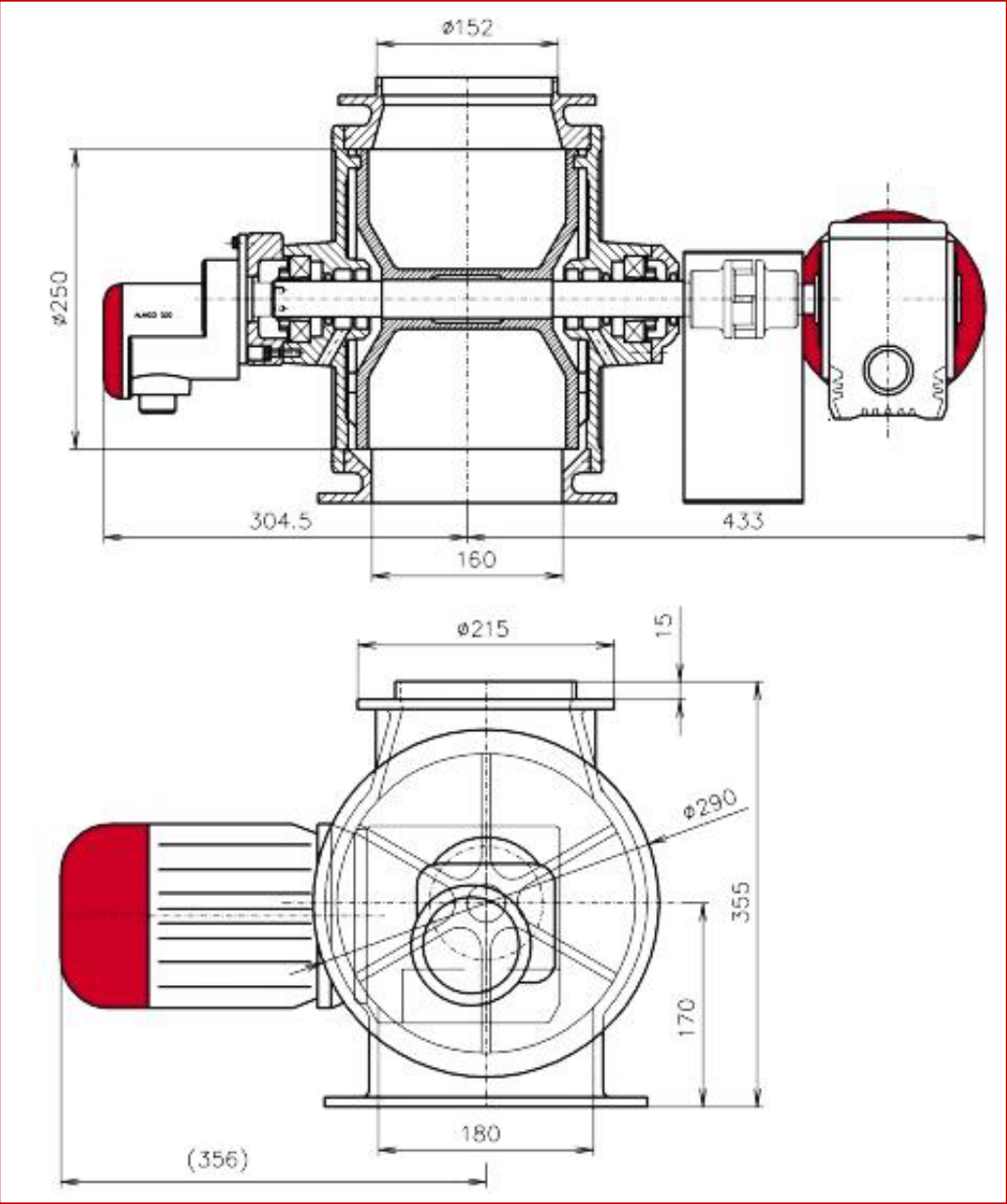

PT 250 with electric motor



**TOROF**  
TOROF

# Air lock device **PT 315.2**

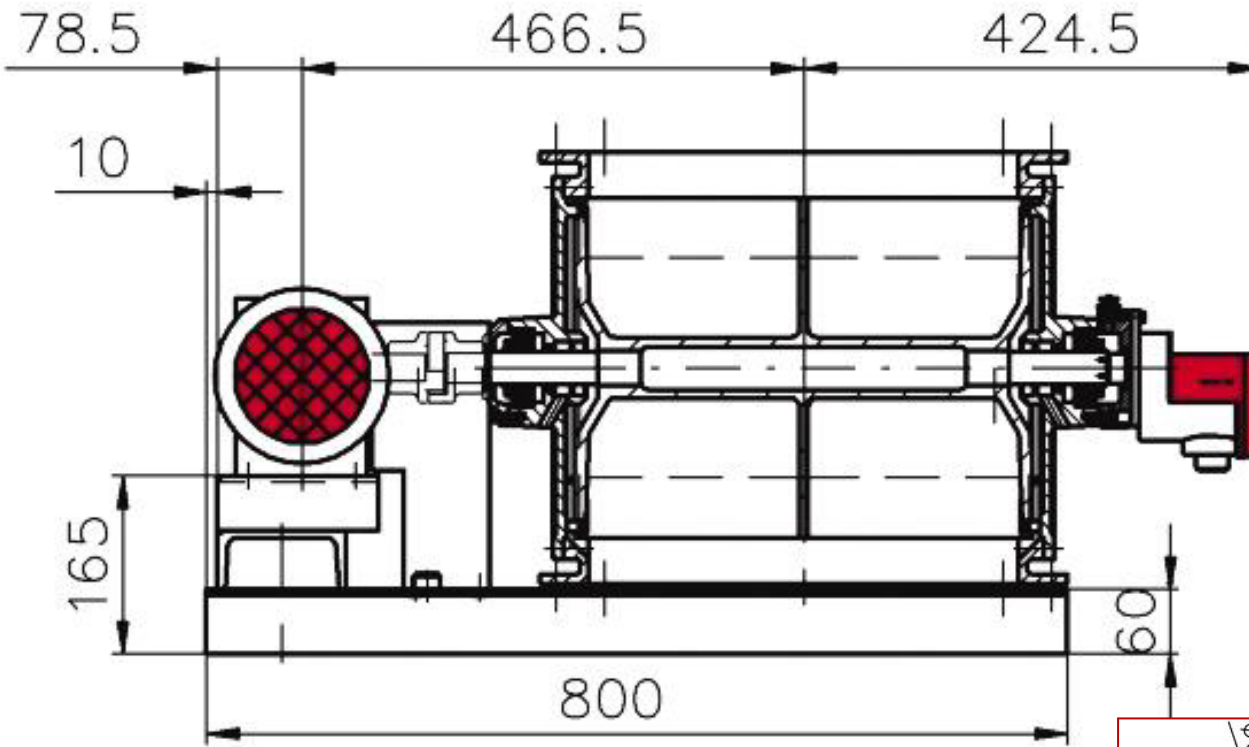

**PP 315.2**

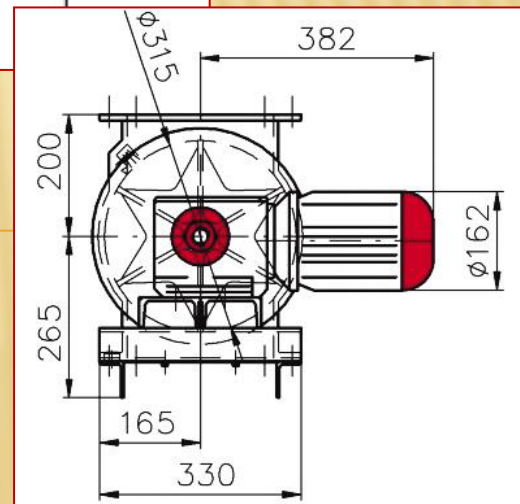



**TORÖFA**



Dělnická 384  
530 00 Pardubice  
CZECH REPUBLIC

**Táňa Mičková**

tel.: + 420 775 200 898

**Roman Janovský**

tel.: + 420 728 332 250

e-mail: [torofa@email.cz](mailto:torofa@email.cz)

web: [www.torofa.cz](http://www.torofa.cz)